

INSTALLATION INSTRUCTIONS TW1 PENDANT WITH P1EM HANGING SYSTEM

These Instructions cover the TWIN LUMINAIRE with the following options:

SERIES	HANGING SYSTEM	SIZE	LIGHT SOURCE	CIRCUIT OPTION	CONTROL	WIRE DIAGRAM
TW1(TWIN)	P1EM: PENDANT WITH VERTICAL AIRCRAFT CABLES TO SEPARATE MOUNTING POINTS AND POWER CORD TO CANOPY	24"	STATIC WHITE	SINGLE CIRCUIT	0-10V DIM 1% (DM1)	WIRE DIAGRAM ON PAGE 7
		36"				
		48"				
		60"		DUAL CIRCUIT		WIRE DIAGRAM ON PAGE 8
		72"				

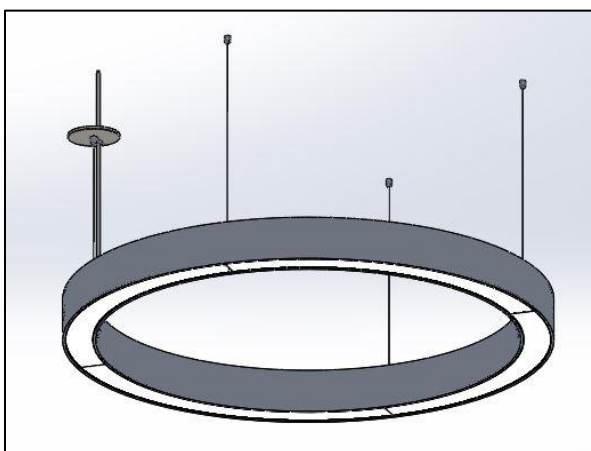

FIG. 1 – TW1-P1EM-XX-MW-XXX-LEDX_XXK-UNV-XX-DM~

GENERAL NOTES:

1. PLEASE COMPLETELY READ THE INSTALL INSTRUCTIONS BEFORE STARTING INSTALLATION.
2. TURN OFF POWER TO CIRCUIT FIXTURE WHILE IT IS BEING INSTALLED.
3. INSTALL IN ACCORDANCE WITH ALL LOCAL, STATE AND NATIONAL CODES CONSULT WITH A QUALIFIED ELECTRICIAN FOR PROPER INSTALLATION.
4. CAREFULLY UNPACK ALL CONTENTS; SOME COMPONENTS MAY HAVE BEEN SHIPPED IN SEPARATE BOXES. MOST FIXTURES ARE SHIPPED PARTIALLY ASSEMBLED. SOME UNASSEMBLY MAY BE REQUIRED FOR INSTALLATION.
5. DO NOT LET THE TWIN LUMINAIRE HANG FREE UNTIL ALL THE AIRCRAFT CABLES ARE SECURED AND EVENLY TENSIONED.
6. DUE TO A CHANGE IN NEC SECTION 410.69 EFFECTIVE IN 2022, THE COLOR PINK WILL BE USED IN PLACE OF GRAY FOR 0-10V CONTROL. NOTE THAT EXISTING SYSTEMS AND FIXTURES MANUFACTURED PRIOR TO 2022 MAY STILL USE GRAY WIRE AS AN UNGROUNDED CONDUCTOR FOR 0-10V CONTROL. CARE SHOULD BE TAKEN WHEN WORKING ON EXISTING SYSTEMS.

OCL Architectural Lighting

Phone: 314.863.1895

Fax: 314.863.3278

www.ocl.com

Table of Contents

GENERAL INFORMATION:	3
MOUNTING:	4
TWIN MOUNTING [HARD CEILING]:	5
TWIN MOUNTING [GRID CEILING]:	5
TWIN MOUNTING [NON-POWERED POINT AIRCRAFT CABLE]:	5
TWIN MOUNTING [CANOPY]:	5

GENERAL INFORMATION:

You will receive the following with each TWIN P1EM series pendant fixture:

1. TWIN LUMINAIRE with CORD attached. (Pre-assembled as shown in FIG. 2)
2. INSTALLATION INSTRUCTIONS (shown in FIG. 3) - Please completely read the install instructions before starting installation.
3. RED BAG (shown in FIG. 3) contains below following items.
 - a. CANOPY (as shown in FIG. 4)
 - b. MOUNTING KIT (as shown in FIG. 5)
 - i. STRAIN RELIEF
 - ii. MOUNTING BRACKET ASSEMBLY
 - iii. THREE (3) CEILING COUPLER (CC)
 - iv. FOUR (4) AIRCRAFT CABLE

WARNING: Examine all components for any damage before beginning installation.

WARNING: This fixture should be installed by a licensed electrician only.

WARNING: Be careful not to scratch or damage any finished parts.

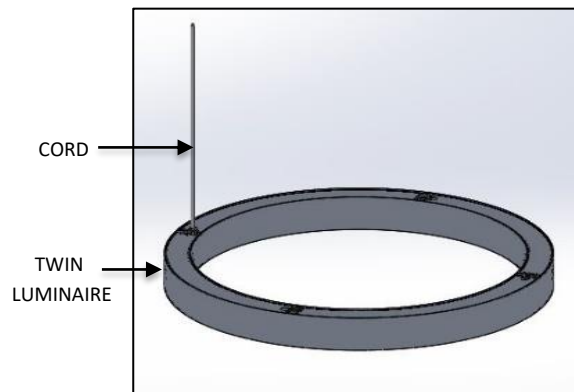

FIG. 2 - TWIN LUMINAIRE (PRE-ASSEMBLED)

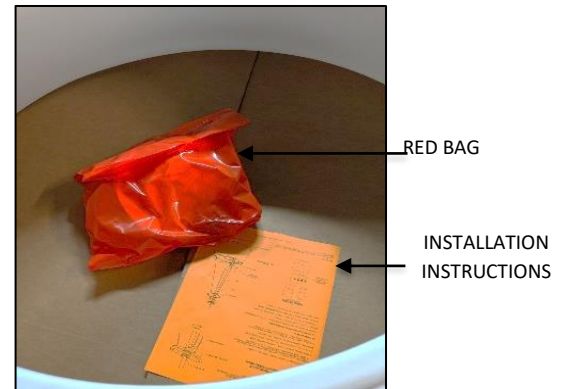

FIG.3 RED BAG AND INSTALLATION INSTRUCTIONS

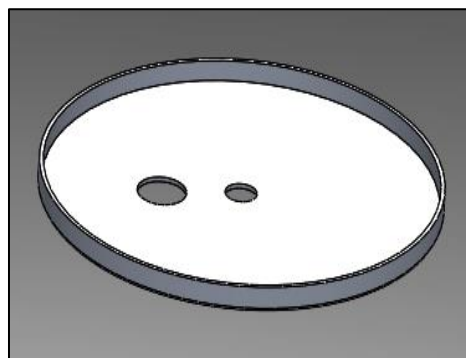

FIG. 4 - CANOPY

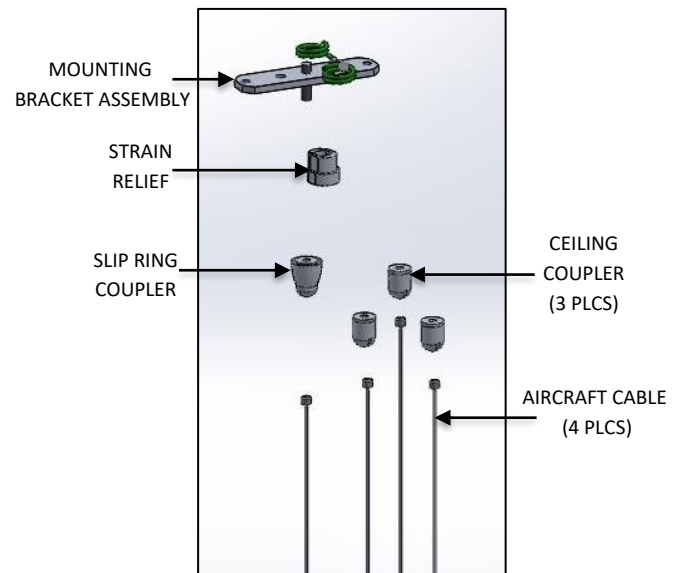

FIG. 5 - MOUNTING KIT CONTENTS

OCL Architectural Lighting

Phone: 314.863.1895

Fax: 314.863.3278

www.oclighting.com

MOUNTING:

1. Mark location for the NON-POWERED MOUNTING POINT according to the MOUNTING INFORMATION TABLE and FIG. 6.

TW1 MOUNTING INFORMATION TABLE						
SERIES	FIXTURE DIAMETER	FIXTURE WEIGHT	MOUNTING DISTANCE		MOUNTING POINT	MIN/MAX OAH
			A	B		
 TW1(TWIN)	24"	35LBS	10.375"	Ø 20.75"	4	12"/144"
	36"	50LBS	16.375"	Ø 32.75"	4	12"/144"
	48"	65LBS	22.375"	Ø 44.75"	4	12"/144"
	60"	80LBS	28.375"	Ø 56.75"	4	12"/144"
	72"	95LBS	34.375"	Ø 68.75"	4	12"/144"

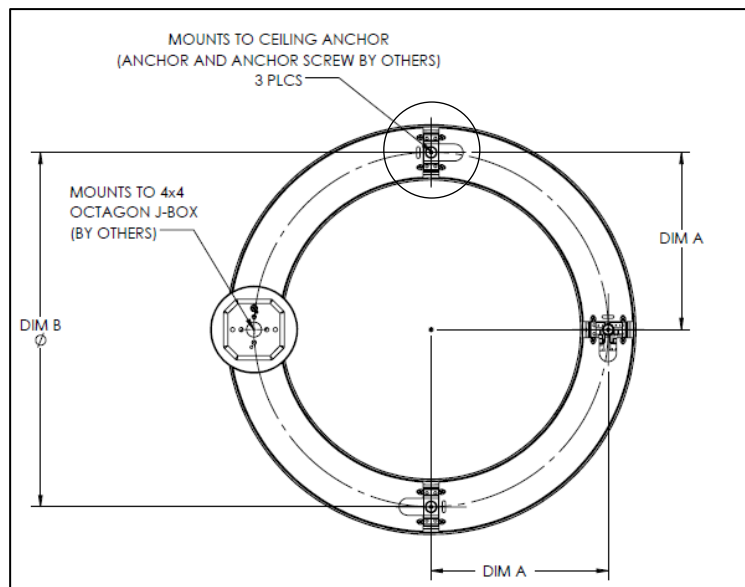

FIG. 6 - TOP VIEW SHOWING MOUNTING VIEW INFORMATION

2. Dis-assemble the CEILING COUPLER into two components CC-BASE, CC-HOLDER as shown in FIG. 7.

For TWIN MOUNTING [HARD CEILING] see steps 3 and 4,
For TWIN MOUNTING [GRID CEILING] see steps 5 and 6.

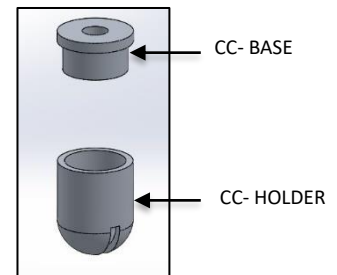

FIG. 7 - CEILING COUPLER ASSEMBLY

OCL Architectural Lighting

Phone: 314.863.1895

Fax: 314.863.3278

www.ocl.com

TW1-P1EM-24_36_48_60_72-INSTALLATION INSTRUCTIONS

TWIN MOUNTING [HARD CEILING]:

- For hard ceiling install #8 FLAT HEAD ANCHOR (by others) into ceiling at the non-powered mounting location as per the mounting information chart (page 4).

WARNING: Anchors (by others) must be rated to 50lbs each and suitable for ceiling material at the non-powered mounting location.

- Install the CC-BASE to the #8 FLAT HEAD ANCHOR (by others) previously installed at the non-powered mounting location and secure with the #8 FLAT HEAD ANCHOR SCREW (by others) as shown in FIG. 8.

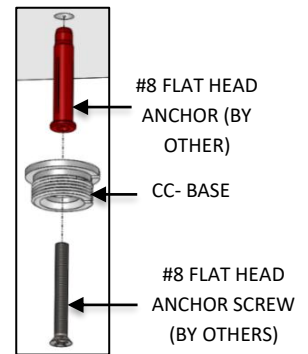

FIG. 8- HARD CEILING
INSTALLATION

TWIN MOUNTING [GRID CEILING]:

- For grid ceiling install 1/4-20 ROD (by others) at the non-powered mounting location as per the mounting information chart (page 4). 1/4-20 ROD should protrude past the bottom of the ceiling surface 0.375".

WARNING: Make sure each threaded rod is mounted to structural member rated to at least 50lbs.

- Add a light thread locking compound to the 1/4-20 ROD (by others). Then thread CC-BASE to 1/4-20 ROD protruding through the ceiling material as shown in FIG. 9.

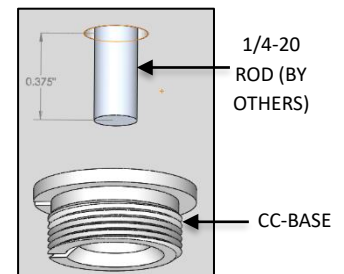

FIG. 9 - GRID CEILING
INSTALLATION

TWIN MOUNTING [NON-POWERED POINT AIRCRAFT CABLE]:

- Locate the AIRCRAFT CABLE mounted to the TWIN fixture.
- Feed all the AIRCRAFT CABLE through the CC-HOLDER. Once fed all the way through, screw CC-BASE and CC-HOLDER together as shown in FIG. 10.

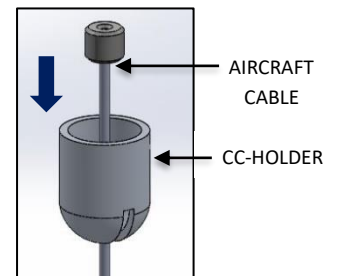

FIG. 10 - SS ROPE CABLE
INSTALLATION

TWIN MOUNTING [CANOPY]:

- Remove STRAIN RELIEF placed around the CORD in the CANOPY. Dis-assemble the SLIP RING COUPLER (1) into three components SRC-BASE, SRC-HOLDER and SRC-FINIAL as shown below in FIG.11.
- Assemble the SRC BASE to the SCREW (Available in mounting bracket assembly) as shown below in FIG.12.

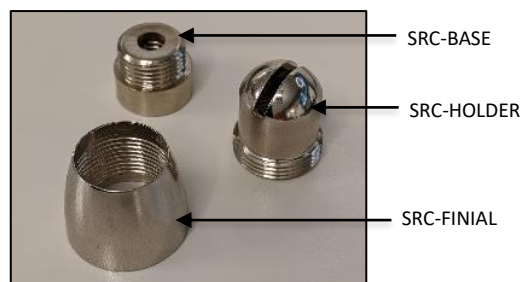

FIG. 11 - SLIP RING COUPLER (1)
CONTENTS

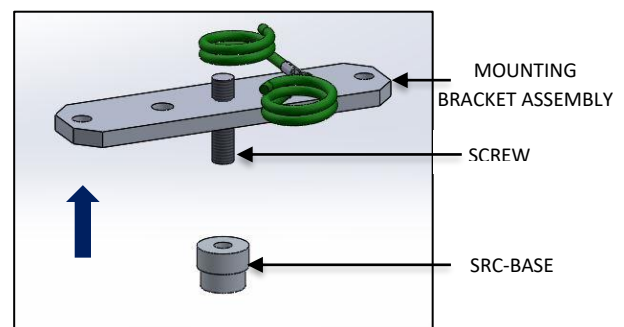

FIG. 12 -SRC-BASE INSTALLATION

OCL Architectural Lighting

Phone: 314.863.1895

Fax: 314.863.3278

www.ocl.com

TW1-P1EM-24_36_48_60_72-INSTALLATION INSTRUCTIONS

11. Assemble the MOUNTING BRACKET ASSEMBLY to the JUNCTION BOX the fixture will mount to (by others) with screws (by others) as shown in below FIG. 13 below.
12. Feed the AIRCRAFT CABLE through the SRC-HOLDER and assemble the SRC-HOLDER to SRC-BASE as shown below in FIG. 14.

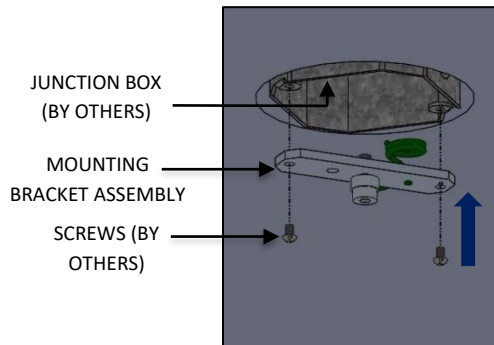

FIG. 13 – MOUNTING BRACKET ASSEMBLY INSTALLATION

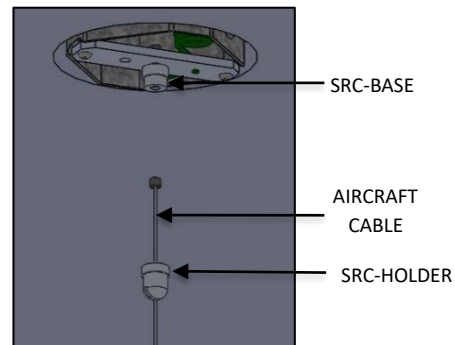

FIG. 14– AIRCRAFT CABLE INSTALLATION

13. Pass the remaining Aircraft cable through the canopy and SRC-FINIAL. Loosely secure CANOPY to the ceiling by threading the SRC-FINIAL to the SRC-HOLDER as shown in FIG. 15.

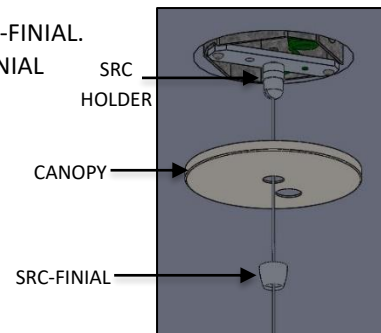

FIG. 15 – CANOPY INSTALLATION

14. Raise the fixture with multiple people and feed all the AIRCRAFT CABLE into the GRIPLOCKS by pressing the plunger of the GRIPLOCK and insert the AIRCRAFT CABLE into the body of the GRIPLOCK and adjust fixture drop to desired height as shown in FIG. 16.

- a. AIRCRAFT CABLE must pass at least 1.75" beyond the body of the GRIPLOCK. When cutting off excess cable always leave at least 1" of cable showing.
- b. Cables may be cut using purpose-built cutters such as Felco C7. Cable will not fray unless passed repeatedly through the Gripper mechanism or otherwise abused.
- c. To prevent fraying of freshly cut ends, re-solder or apply a drop of super-glue.
- d. Proper CABLE adjustment is critical for these FIXTURES. Improper CABLE adjustment will result in uneven tension and may cause the FIXTURE BODY to bow.

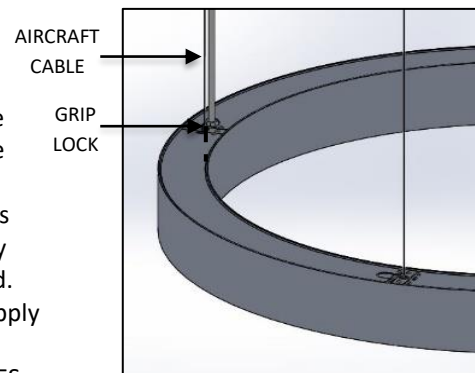

FIG. 16 – FIXTURE INSTALLATION



WARNING:

Do not let the TWIN LUMINAIRE hang free until all the AIRCRAFT CABLES are secured and evenly tensioned.

OCL Architectural Lighting

Phone: 314.863.1895

Fax: 314.863.3278

www.ocl.com

TW1-P1EM-24_36_48_60_72-INSTALLATION INSTRUCTIONS

15. Verify that the acrylic panels are lying flat and positioned evenly.
16. Once the TWIN BODY is secured to the AIRCRAFT CABLE (4) at the GRIPLOCK (4) Unthread the FINIAL from the MOUNTING BRACKET ASSEMBLY and lower the CANOPY as shown below in FIG. 17.
17. Feed POWER CORD through the second Hole in the CANOPY and secure CORD to CANOPY with CORD STRAIN RELIEF as shown below in FIG. 18.

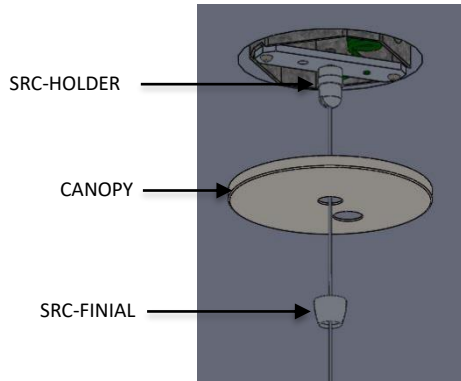

FIG. 17 – CANOPY DIS-ASSEMBLY

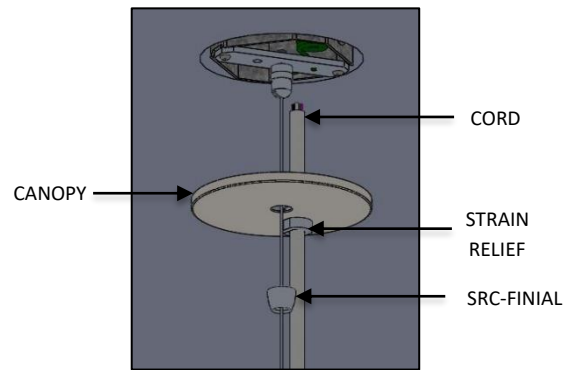

FIG. 18 – CORD INSTALLATION

18. See WIRE DIAGRAM as shown below and WIRE LABEL TABLE below for wire connections. Make all wire connections in accordance with the NATIONAL ELECTRICAL CODE and all applicable LOCAL AND STATE CODES.

SERIES	HANGING SYSTEM	SIZE	LIGHT SOURCE	CIRCUIT OPTION	CONTROL	WIRE DIAGRAM
TW1(TWIN)	P1EM: PENDANT WITH VERTICAL AIRCRAFT CABLES TO SEPARATE MOUNTING POINTS AND POWER CORD TO CANOPY	24"	STATIC WHITE	SINGLE CIRCUIT	0-10V DIM 1% (DM1)	WIRE DIAGRAM ON PAGE 7
		36"				
		48"		DUAL CIRCUIT		WIRE DIAGRAM ON PAGE 8
		60"				
		72"				

SINGLE CIRCUIT WIRE DIAGRAM:

WIRE LABEL TABLE	
WIRE COLOR	LABEL
BLACK	LINE VOLTAGE
WHITE	NEUTRAL
GREEN	GROUND
DM1 DIMMING OPTION	
PURPLE	0-10V DIMMING (+)
PINK	0-10V DIMMING (-)

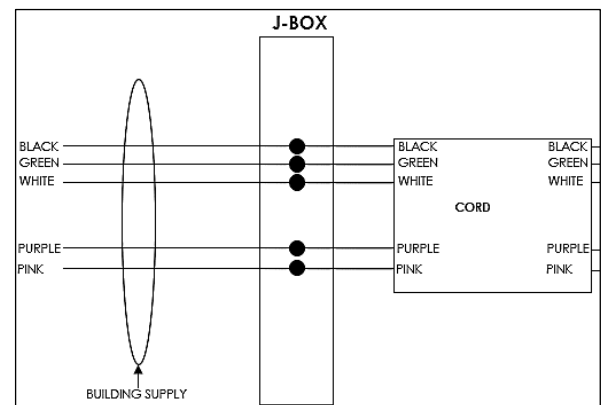

SEE GENERAL NOTE 6 ON PAGE 1

FIG. 19 – WIRE DIAGRAM FOR ALL MODELS

OCL Architectural Lighting

Phone: 314.863.1895

Fax: 314.863.3278

www.ocllighting.com

DUAL CIRCUIT WIRE DIAGRAM:

DUAL CIRCUIT (TWO CORDS)

CORD FOR UPLIGHT:

BLACK WIRE = UPLIGHT LINE VOLTAGE

PURPLE WIRE = UPLIGHT 0-10V (+)

PINK WIRE = UPLIGHT 0-10V (-)

CORD FOR DOWN LIGHT:

BLACK WIRE = DOWNLIGHT LINE VOLTAGE

PURPLE WIRE = DOWNLIGHT 0-10V (+)

PINK WIRE = DOWNLIGHT 0-10V (-)

GREEN = UP AND DOWNLIGHT GROUND

WHITE WIRE = UP AND DOWNLIGHT NEUTRAL

FIG. 20 - WIRE CONNECTION FROM BUILDING
SUPPLY TO DRIVER

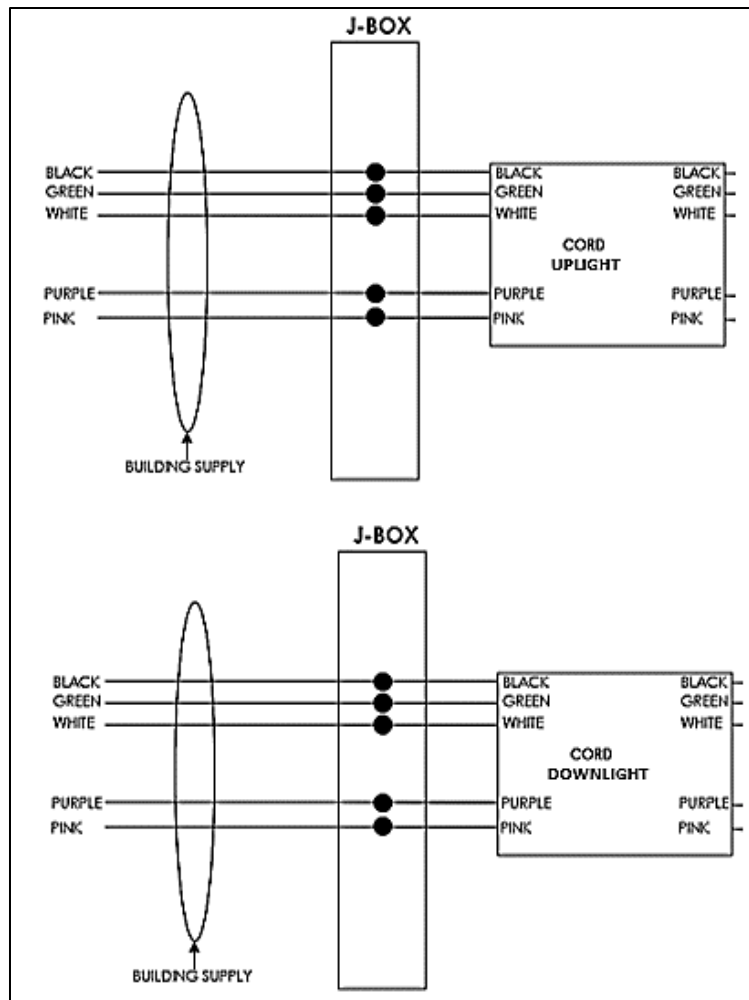

SEE GENERAL NOTE 6 ON PAGE 1

FIG. 21 – WIRE DIAGRAM FOR ALL MODELS

OCL Architectural Lighting

Phone: 314.863.1895

Fax: 314.863.3278

www.ocl.com

TW1-P1EM-24_36_48_60_72-INSTALLATION INSTRUCTIONS

19. Raise CANOPY and secure to ceiling by threading the SRC-FINIAL to SRC-HOLDER.as shown below in FIG.22.

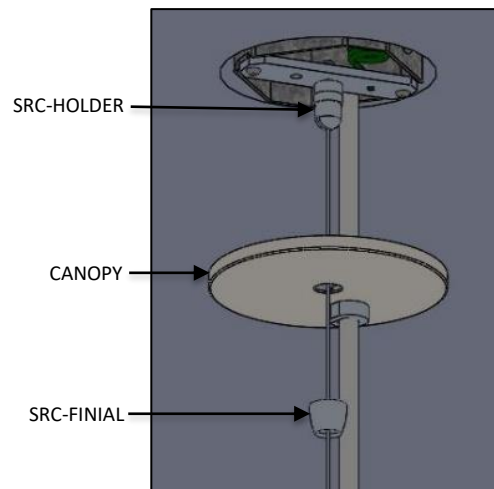

FIG. 22 – FINIAL INSTALLATION

20. Restore power to circuit the TWIN series pendant is connected to.
 - a. Test to see that the luminaire turns on after power is restored.
 - b. Contact OCL for any Luminaire troubleshooting if a problem occurs.

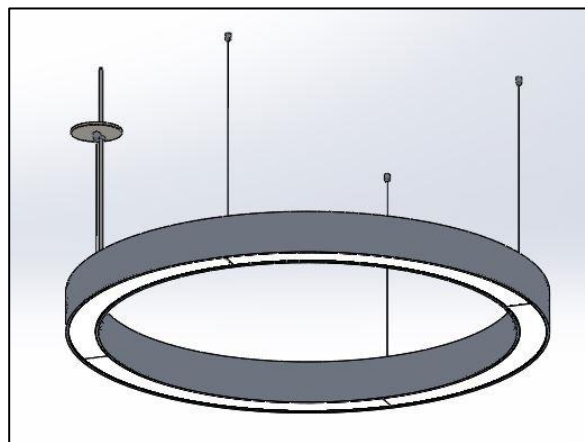

FIG. 23 - COMPLETED INSTALLATION OF TW1 PENDANT WITH P1EM HANGING SYSTEM

OCL Architectural Lighting

Phone: 314.863.1895

Fax: 314.863.3278

www.ocl.com